

Front Wheel WH-MT500-CL-F15-B-275

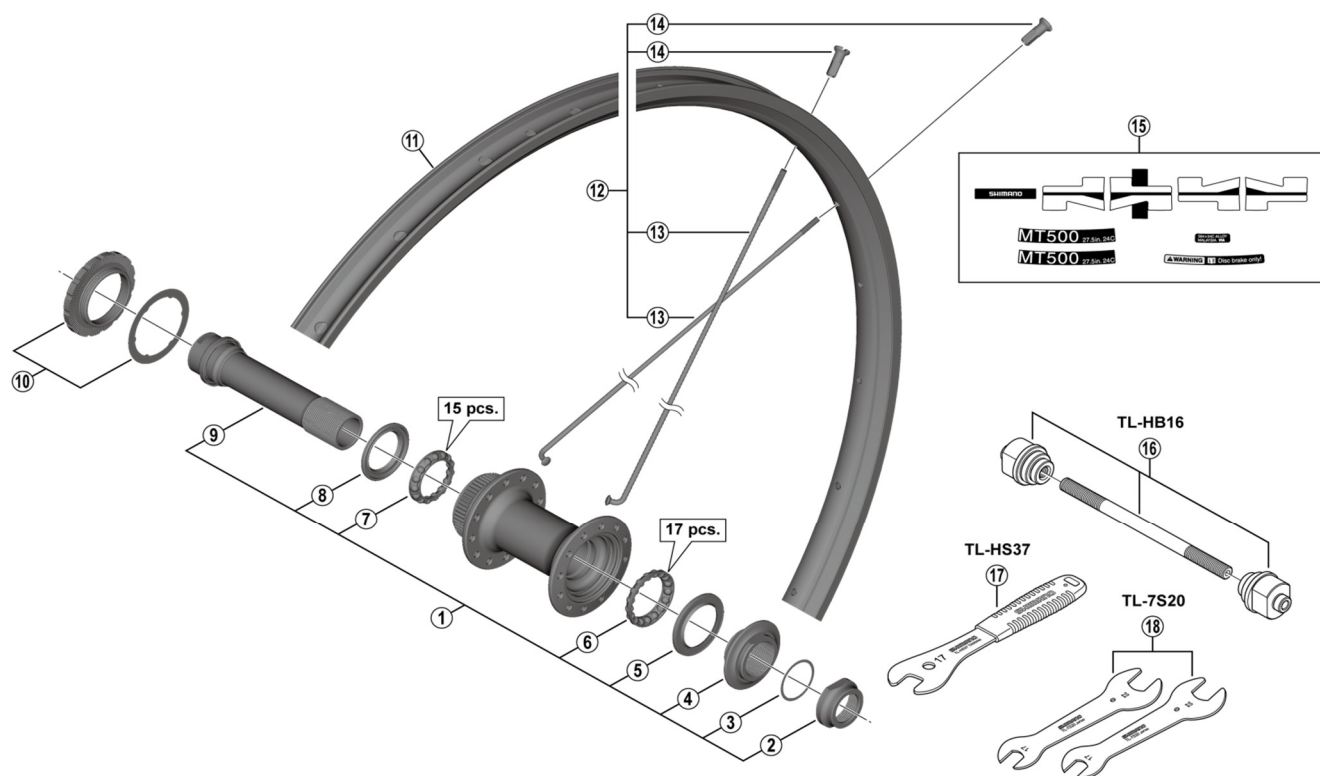

• Over Lock Nut Dimension: 110 mm (4-11/32")

ITEM NO.	SHIMANO CODE NO.	DESCRIPTION	INTERCHANGEABILITY		
			A	A	A
1	Y2AJ98010	Complete Hub Axle	A	A	
2	Y24612000	Right Hand Lock Nut	A	A	
3	Y24613000	Adjusting Washer	A	A	
4	Y24698040	Right Hand Cone w/Dust Cap	A	A	
5	Y27X15000	Right Hand Seal Ring	A	A	A
6	Y27X98030	Right Hand Ball Retainer (5/32" x 17)	A	A	A
7	Y27X98040	Left Hand Ball Retainer (5/32" x 15)	A	A	A
8	Y27X14000	Left Hand Seal Ring	A	A	A
9	Y2AJ98020	Hub Axle Unit	A	A	B
10	Y24698030	Lock Ring & Washer	A	A	B
11	-	Rim {24H}			
12	-	Spoke Unit {Spoke (272 mm x 24 pcs.) / Nipple (24 pcs.)}			
13	Y0ERS2100	Spoke (272 mm)			
14	Y012Y3352	Nipple			
15	Y0EJ98010	Rim Sticker Unit			
16	Y20W98020	TL-HB16 Hub Setting Tool	A	A	A
17	Y23098030	TL-HS37 Hub Spanner (17 mm)	A	A	A
18	Y13098900	TL-7S20 Hub Spanner (17 mm x 22 mm) 2 pcs.	A	A	A

A: Same parts.

B: Parts are usable, but differ in materials, appearance, finish, size, etc.

Absence of mark indicates non-interchangeability.

Specifications are subject to change without notice.

WH-MT15-A-CL-F15-275

WH-MT35-CL-F15-275

WH-M8020-TL-F15-B-275

Nov.-2017-4315

© Shimano Inc. I

SHIMANO